

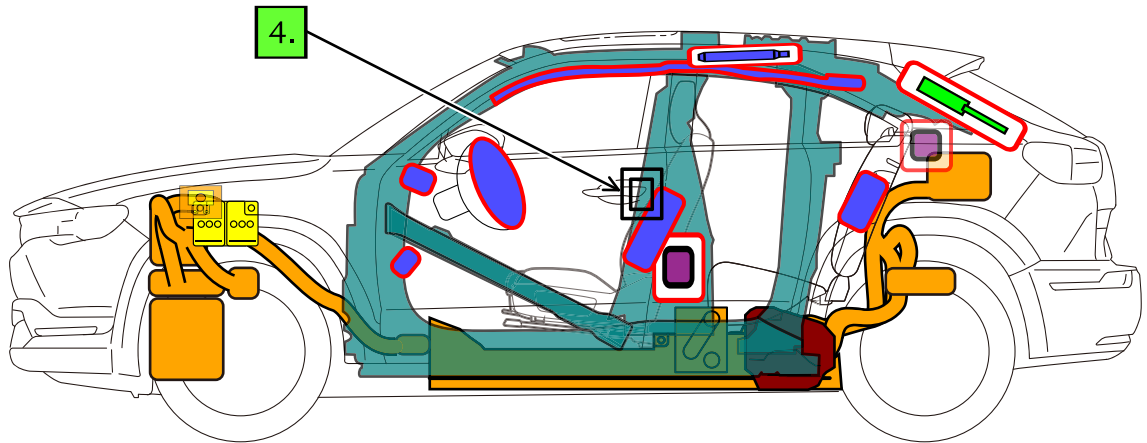

MAZDA MX-30

(2023-)

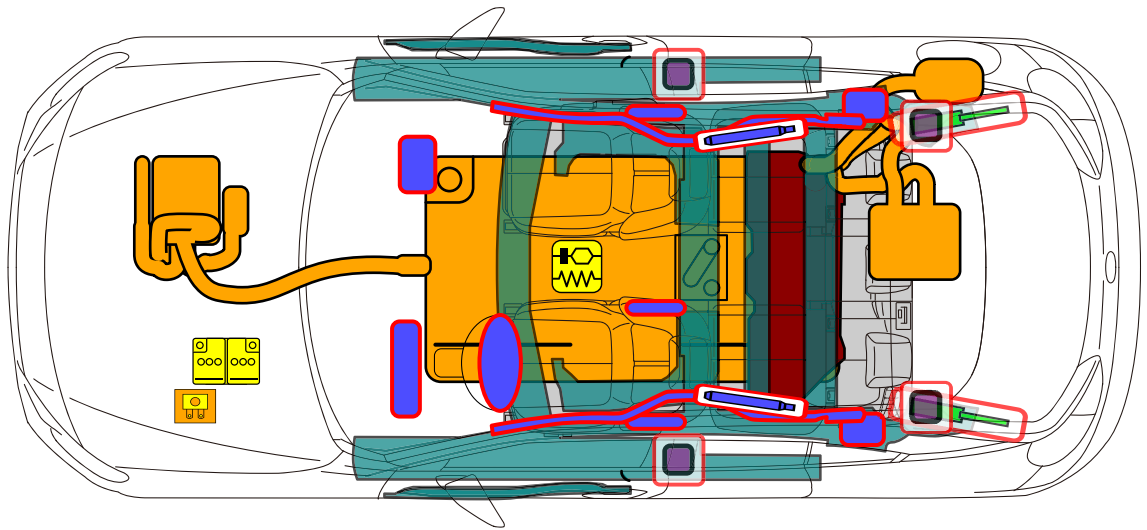
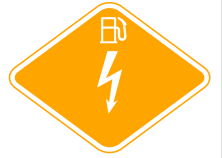

	Airbag		Stored gas inflator		Seat belt pretensioner		SRS control unit		Gas strut / Preloaded spring
	High strength zone		Zone requiring special attention		Battery low voltage		High voltage battery pack		High voltage power cable / component
	High voltage disconnect		Fuse box disabling high voltage system		Fuel tank content gasoline / ethanol				

MAZDA MX-30 (2023-)

1. Identification / recognition



LACK OF ENGINE NOISE DOES NOT MEAN VEHICLE IS OFF: SILENT MOVEMENT OR INSTANT RESTART CAPABILITY EXISTS UNTIL VEHICLE IS FULLY SHUT DOWN. WEAR APPROPRIATE PPE.



2. Immobilisation / stabilisation / lifting

IMMOBILIZE THE VEHICLE

- Block the wheels.
- Set the parking brake.
- Put the car in P position.

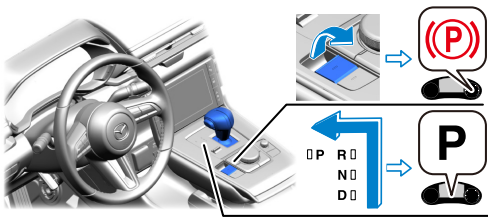

LIFTING POINTS

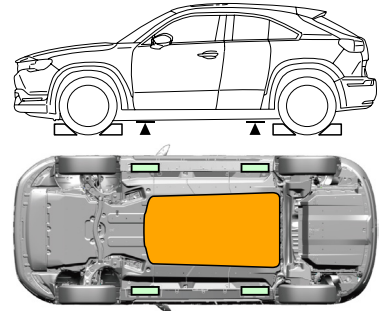

Appropriate lifting points High voltage battery

3. Disable direct hazards / safety regulations

Systems that do not operate if power is lost



Door lock



Power window

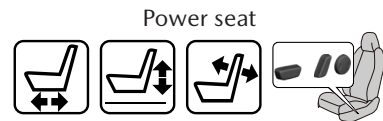

Power seat

Shift-by-wire



Electric parking brake (EPB)



Electric liftgate opener



Procedure when EV is connected for charging

Charge connector is unlocked

1. Remove the charge connector.



Charge connector is locked

1. Remove the rear mud guard on the right side.
2. Insert a hand from inside the tire housing and pull the charge connector lock manual release lever in the release direction shown in the figure.
3. Remove the charge connector with the charge connector lock manual release lever pulled.

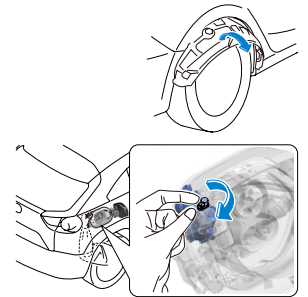

Procedure for disabling high voltage system

Preferred procedure

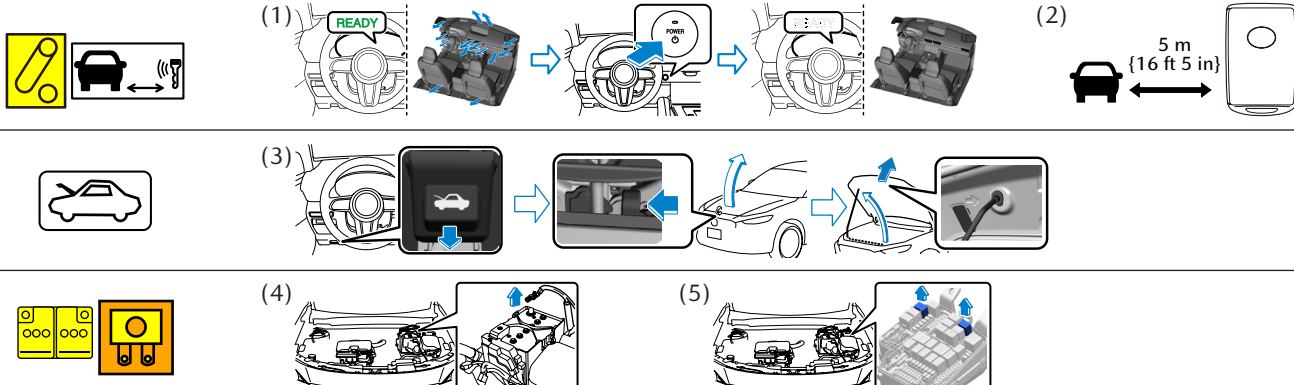

MAZDA MX-30 (2023-)

 Alternative procedure

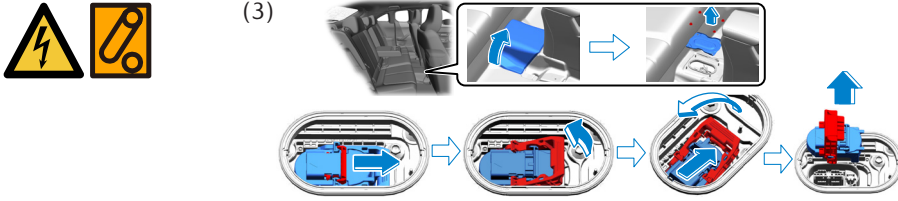
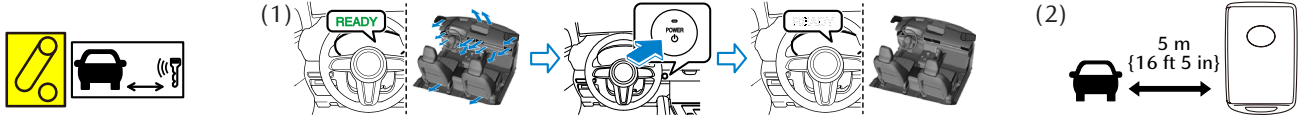

4. Access to the occupants

Glass types

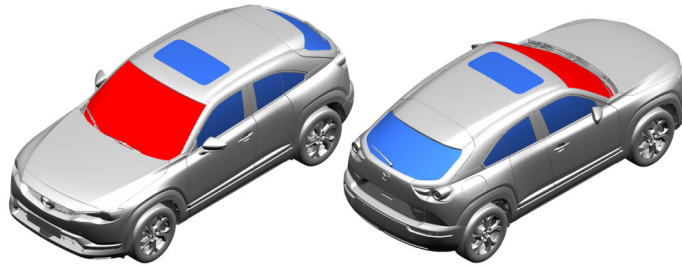
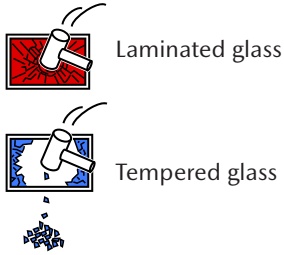

High strength steel in body

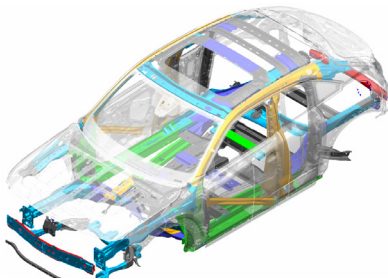

- 1800 MPa {18355 kgf/cm², 261068 psi}
- 1500 MPa {15296 kgf/cm², 217557 psi}
- 1310 MPa {13358 kgf/cm², 190000 psi}
- 1180 MPa {12032 kgf/cm², 171145 psi}
- 980 MPa {9993 kgf/cm², 142137 psi}
- 780 MPa {7954 kgf/cm², 113130 psi}
- 590 MPa {6016 kgf/cm², 85572 psi}

Steering wheel angle adjustment

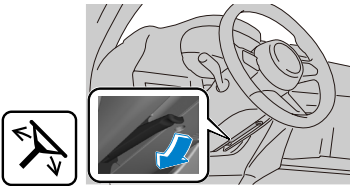



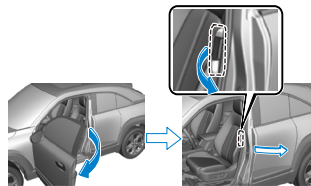



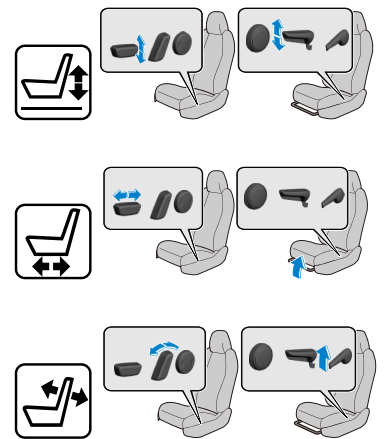





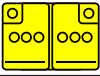

Free-style door operation method



Seat position operation



5. Stored energy / liquids / gases / solids

	Li-ion / DC 355V	  
	Pb / DC 12V	  
	R-1234yf / 1125 g {39.68 oz}	  
	Gasoline / 50.0 L {13.2 US gal, 11.0 Imp gal}	 



THE BATTERY ASSEMBLY COVER SHOULD NEVER BE BREACHED OR REMOVED UNDER ANY CIRCUMSTANCES, INCLUDING FIRE. DOING SO MIGHT RESULT IN SEVERE ELECTRIC BURNS, SHOCKS, OR ELECTROCUTION.

MAZDA MX-30 (2023-)

6. In case of fire



EXTINGUISH THE FIRE USING LARGE AMOUNTS OF WATER OR AN ABC FIRE EXTINGUISHER.



BATTERY RE-IGNITION!

7. In case of submersion



- DO NOT TOUCH ANY HIGH VOLTAGE PARTS WHEN THE VEHICLE IS SUBMERGED OR PARTIALLY SUBMERGED IN WATER.
- IF THE HIGH VOLTAGE BATTERY IS DAMAGED OR YOU ARE UNSURE WHETHER OR NOT IT IS DAMAGED, PERFORM THE RESCUE OPERATION WHILE WEARING THE APPROPRIATE INSULATING PROTECTIVE EQUIPMENT.
- AFTER PULLING THE VEHICLE OUT OF THE WATER, DRAIN THE INTERIOR OF THE VEHICLE AND REMOVE THE SERVICE PLUG.

8. Towing / transportation / storage

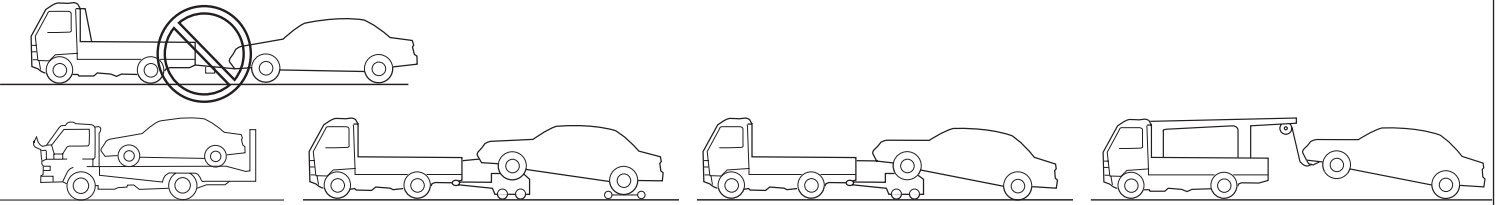

BATTERY RE-IGNITION!



KEEP THE VEHICLE OUTDOORS AWAY FROM FLAMMABLES.

10. Explanation of pictograms used

	Hybrid Electric Vehicle on fuel of liquid group 2.		General warning sign		Hazardous to the human health
	Bonnet		Warning, Electricity		Remove smart key
	Device to shut down power in vehicle		Use thermal Infrared camera		Door-lock control
	Steering wheel, tilt control		Use water to extinguish the fire		Window lift (power-operated)
	Seat adjustment, longitudinal		Use ABC powder to extinguish the fire		Parking brake
	Seat height adjustment		Explosive		Laminated glass
	Seat adjustment, seat back recline		Gases under pressure		Tempered glass
	Lifting point; central support		Flammable		
	Air conditioning component		Corrosives		